

Ex-d/e metal reducing rings/screw plugs



Reducing rings



Screw plug

3

Technical data

Ex-d metal reducing rings | screw plug | adapter ISO-NPT

Marking accd. to 2014/34/EU	⊕ II 2 G Ex e II Gb / Ex d II Gb / Ex d IIC / ⊕ II 2 D tb IIIC Db
EC-Type Examination Certificate	SIRA 10 ATEX 1225 X
Permissible ambient temperature	-60 °C to +200 °C
Degree of protection accd. to EN 60529	IP66 / IP68 - 10 bar
Enclosure material	Nickel-plated brass (stainless steel, bronze, natural brass option)

Please use sealing washers (see page 2.3.28).



Reducing rings

Ordering details

Thread 1 (male)	Thread 2 (female)	A mm	L mm	E mm	Order No.
Reducing rings ISO for metric thread, CuZn gal. Ni					
M16 x 1.5	M12 x 1.5	18	2.8	15	CAP 745 834
M20 x 1.5	M12 x 1.5	23	3.0	15	CAP 745 844
M20 x 1.5	M16 x 1.5	23	3.0	15	CAP 740 024
M25 x 1.5	M16 x 1.5	28	3.0	15	CAP 740 034
M25 x 1.5	M20 x 1.5	28	3.0	15	CAP 740 294
M32 x 1.5	M20 x 1.5	36	3.5	15	CAP 740 304
M32 x 1.5	M25 x 1.5	36	3.5	15	CAP 740 564
M40 x 1.5	M25 x 1.5	44	4.0	15	CAP 740 574
M40 x 1.5	M32 x 1.5	44	4.0	15	CAP 740 834
M50 x 1.5	M32 x 1.5	54	5.0	16	CAP 740 844
M50 x 1.5	M40 x 1.5	54	5.0	16	CAP 741 104
M63 x 1.5	M40 x 1.5	67	5.5	17	CAP 741 114
M63 x 1.5	M50 x 1.5	67	5.5	17	CAP 741 374
M75 x 1.5	M32 x 1.5	80	6.0	18	CAP 740 864
M75 x 1.5	M40 x 1.5	80	6.0	18	CAP 741 124
M75 x 1.5	M50 x 1.5	80	6.0	18	CAP 741 384
M75 x 1.5	M63 x 1.5	80	6.0	18	CAP 741 644
M90 x 2.0	M63 x 1.5	95	8.0	22	CAP 745 854
M90 x 2.0	M75 x 2.0	95	8.0	22	CAP 745 864
M100 x 2.0	M75 x 2.0	110	10.0	22	CAP 745 874
M100 x 2.0	M90 x 2.0	120	10.0	22	CAP 745 914
M110 x 2.0	M90 x 2.0	120	11.0	22	CAP 745 924
M110 x 2.0	M100 x 2.0	120	11.0	22	CAP 745 934
Reducing rings NPT, CuZn gal. Ni					
3/8"	1/4"	18	2.8	12	CAP 745 574
1/2"	2/4"	22	3.0	16	CAP 745 584
1/2"	3/8"	22	3.0	16	CAP 745 594
3/4"	3/8"	28	3.0	16	CAP 745 604
3/4"	1/2"	28	3.0	16	CAP 744 884
1"	1/2"	36	3.5	20	CAP 744 894
1"	3/4"	36	3.5	20	CAP 745 154
1"1/4	3/4"	44	4.0	20	CAP 745 164
1"1/4	1"	44	4.0	20	CAP 745 424
1"1/2	1"	50	5.0	20	CAP 745 434
1"1/2	1"1/4	50	5.0	20	CAP 745 694
2"	1"	64	5.5	20	CAP 745 444
2"	1"1/4	64	5.5	20	CAP 745 704
2"	1"1/2	64	5.5	20	CAP 745 964
2"1/2	1"1/2	75	6.0	28	CAP 745 974
2"1/2	2"	75	6.0	28	CAP 746 234
3"	2"	90	8.0	30	CAP 746 244
3"	2"1/2	90	8.0	30	CAP 746 504
3"1/2	2"1/2	110	10.0	32	CAP 745 654
3"1/2	3"	110	10.0	32	CAP 745 664
4"	3"	120	11.0	32	CAP 746 834
4"	3"1/2	120	11.0	32	CAP 745 734

Ex-d/e metal reducing rings/screw plugs



Screw plug

3

Ordering details

Thread 1 (male)	A mm	L mm	E mm	Order No.
Screw plug with ISO thread, CuZn gal. Ni				
M12 x 1.5	14	2.8	15	CAP 190 124
M16 x 1.5	18	3.0	15	CAP 190 164
M20 x 1.5	23	3.0	15	CAP 190 204
M25 x 1.5	28	3.5	15	CAP 190 254
M32 x 1.5	36	4.0	15	CAP 190 324
M40 x 1.5	44	4.0	15	CAP 190 404
M50 x 1.5	54	5.0	16	CAP 190 504
M63 x 1.5	67	5.5	17	CAP 190 634
Screw plug with NPT thread, CuZn gal. Ni				
1/4 "	14	2.8	12	CAP 190 194
3/8 "	18	2.8	12	CAP 190 294
1/2 "	22	3.0	16	CAP 190 394
3/4 "	28	3.0	16	CAP 190 494
1 "	36	3.5	20	CAP 190 594
1 " 1/4	44	4.0	20	CAP 190 694
1 " 1/2	50	5.0	20	CAP 190 794
2 "	64	5.5	20	CAP 190 894
2 " 1/2	75	6.0	28	CAP 190 994
3 "	90	8.0	30	CAP 191 094
3 " 1/2	110	10.0	32	CAP 191 194
4 "	120	11.0	32	CAP 191 294

Please use sealing washers (see page 2.3.28).



Adapter rings

3

Ordering details

Thread 1 (male)	Thread 2 (female)	A mm	L mm	E mm	Ø D mm	Order No.
Adapter ISO - NPT, CuZn gal. Ni						
M20 x 1.5	1/2 " NPT	24	18	15	15.5	CAP 744 704
M20 x 1.5	3/4 " NPT	30	18.5	15	15.5	CAP 744 964
M25 x 1.5	3/4 " NPT	30	18.5	15	20.3	CAP 744 974
M25 x 1.5	1 " NPT	38	22.5	15	20.3	CAP 745 234
M32 x 1.5	1 " NPT	38	22.5	15	27.3	CAP 745 244
M32 x 1.5	1 " 1/4 NPT	48	22.5	15	27.3	CAP 745 504
M40 x 1.5	1 " 1/4 NPT	48	22.5	15	35.3	CAP 745 514
M40 x 1.5	1 " 1/2 NPT	52	22.5	15	35.3	CAP 745 774
M50 x 1.5	2 " NPT	64	22.5	16	45.2	CAP 746 044
M63 x 1.5	2 " NPT	67	22.5	17	53.6	CAP 746 054
M63 x 1.5	2 " 1/2 NPT	77	31	17	57.8	CAP 746 314
Adapter NPT - ISO, CuZn gal. Ni						
1/2 „ NPT	M20 x 1.5	23	18.5	16	15.0	CAP 740 454
1/2 „ NPT	M25 x 1.5	28	19.0	16	15.0	CAP 740 714
3/4 „ NPT	M25 x 1.5	28	19.0	16	20.1	CAP 740 724
3/4 „ NPT	M32 x 1.5	36	19.0	16	20.1	CAP 740 984
1 „ NPT	M32 x 1.5	36	19.0	20	26.0	CAP 740 994
1 „ NPT	M40 x 1.5	44	19.0	20	26.0	CAP 741 254
1 „ 1/4 NPT	M40 x 1.5	44	19.0	20	34.8	CAP 741 264
1 „ 1/4 NPT	M50 x 1.5	54	20.0	20	34.8	CAP 741 524
1 „ 1/2 NPT	M50 x 1.5	54	20.0	20	40.8	CAP 741 534
1 „ 1/2 NPT	M63 x 1.5	67	21.0	20	40.8	CAP 741 794
2 „ NPT	M63 x 1.5	67	21.0	20	52.4	CAP 741 804

Please use sealing washers (see page 2.3.28).

Dimension drawing

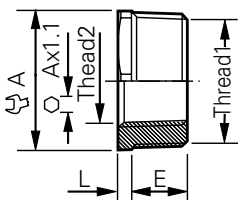

Authorised Distributor:

46, Jalan SS 22/21, Damansara Jaya,
47400 Petaling Jaya,
Selangor Darul Ehsan, Malaysia.

Skype ID: AmpmechSkype
Email: ampmech@ampmech.com
Website: www.ampmech.com

Dimensions in mm