

Separator AS 2

Liquid separator with integrated trap

Technical data

Connection DN	15 - 50
Connection G	1/2 - 2
Nominal pressure PN	16
Operating pressure	0 - 13 bar
Collection efficiency	max. 1200 l/h
Temperature	190 °C
Medium	gases and steam

Description

Centrifugal separators use the cyclone principle to separate automatically liquids, solids and steam from gas flows while the gas is under operating pressure. The liquid trap built into the separator body operates instantaneously and its operation is not impaired by back pressure or pressure fluctuations. The collected liquid is safely drained by the float control. No additional energy input is required.

Separators type AS 2 are of inline design and have their drain outlets at the bottom. For a nominal width of DN 15 - 25 and G 1/2 - 1, the outlet is arranged at the bottom, and for a nominal width of DN 40 - 50 and G 1 1/2 - 2, it is arranged laterally. Being entirely constructed of corrosion-resistant stainless steel, they can be used universally, i.e. especially for corrosive media. The optimised flow geometry allows a separation performance of 99 %. The maximum separation capacity is achieved at a flow velocity of 25 – 30 m/s. The flow velocity should not exceed 35 m/s.

Top and bottom sections of the valve body are connected by a clamp ring and two bolts. Servicing/maintenance is easy and does not call for special tooling.

Standard

- » All stainless steel construction
- » Quick-release body clamp ring
- » Combined valve with integrated trap

Options

- » Various seal materials to suit your medium
- » Expansion pipe connection in body top section for separating liquids from compressed air or gases
- » Other connections on request
- » Special designs on request

Product



Picture similar

Technical specification

Collection Efficiency [l/h] and Pressure Ranges [bar]

Δp bar	G 1/2 - 1, DN 15 - 25			G 1 1/2 - 2, DN 40 - 50
	pressure range bar			pressure range bar
	0 - 2	0 - 6	0 - 12	0 - 13
0.1	70	19	6	220
0.2	100	28	9	320
0.5	160	40	12	710
1	230	70	18	980
2	350	110	27	1200
4	-	160	46	1200
6	-	200	50	1200
8	-	-	60	1200
10	-	-	70	1180
12	-	-	75	1030
13	-	-	-	950

max. flow rate

medium	nominal diameter	
	G 1/2 - 1, DN 15 - 25	G 1 1/2 - 2, DN 40 - 50
gases	400 Nm³/h	1000 Nm³/h
steam	175 kg/h	400 kg/h

Separator AS 2

Liquid separator with integrated trap

Materials

Materials		
Nominal diameter	G 1/2 - 1, DN 15 - 25	G 1 1/2 - 2, DN 40 - 50
Body	stainless steel 1.4404 / 316L	stainless steel 1.4404 / 316L
Body seal	EPDM optional FEPM	EPDM optional FEPM
Seat, Cone	stainless steel 1.4404 / 316L	stainless steel 1.4404 / 316L
Float	stainless steel 1.4404 / 316L	stainless steel 1.4404 / 316L
Valve seal	FFKM	stainless steel 1.4404 / 316L

*All materials equal or of higher quality

Dimensions and weights

Dimensions sleeve connection [mm]				
size	nominal diameter			
	G 1/2	G 1	G 1 1/2	G 2
A*	165	155	195	on request
A _E	-	-	238	on request
B	221	225	330	330
D	140	140	200	200
E	G 1/2A	G 1/2A	G 3/4A	G 3/4A

Dimensions sleeve connection [mm]				
size	nominal diameter			
	DN 15	DN 25	DN 40	DN 50
A*	165	155	240	295
A _E	-	-	260	288
B	221	225	330	330
D	140	140	200	200
E	G 1/2A	G 1/2A	G 3/4A	G 3/4A

*overall length tolerances in acc. with DIN EN 558

Weights sleeve connection [kg]				
nominal diameter outlet				
G 1/2	G 1	G 1 1/2	G 2	
2.6	2.6	3.5	on request	

Weights flange connection [kg]				
nominal diameter outlet				
DN 15	DN 25	DN 40	DN 50	
on request	5	10	11.5	

Customs tariff number	
84818099	

G 1, DN 25

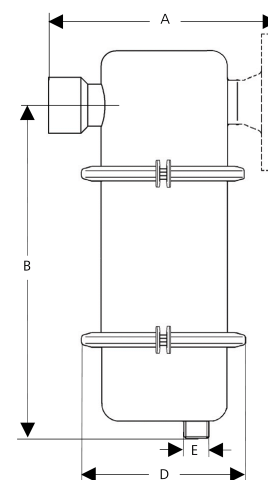

G 1 1/2, DN 40

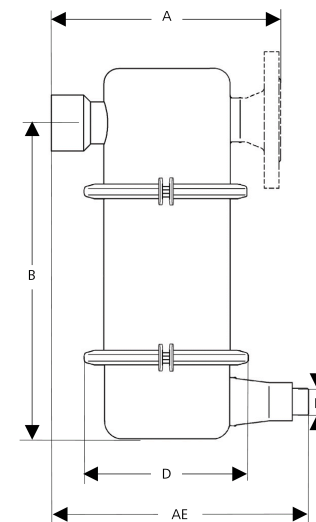

Mankenberg GmbH | Spenglerstrasse 99 | D-23556 Luebeck | Germany

Authorised Distributor:



46, Jalan SS 22/21, Damansara Jaya,
47400 Petaling Jaya,
Selangor Darul Ehsan, Malaysia.

Email: ampmech@ampmech.com

Website: www.ampmech.com

Please send us your enquiry and allow us to advise you. Special designs on request.
The pressure has always been indicated as overpressure. Mankenberg reserves the right to alter technical specifications without notice.