

# LEVEL CONTROL Steam trap KA 2

Valve for small flow rates



## Technical data

Connection DN	25 x 3/4A
Connection G	1/2 x 1/2A
	3/4 x 1/2A
	1 x 3/4A
Nominal pressure PN	16
Operating pressure	0 - 13 bar
Flow rate	2 - 1570 l/h
Temperature	190 °C
Medium	steam

## Description

Steam traps automatically drain condensate without loss of steam or gas. They operate instantaneously and are not affected by back pressure or pressure fluctuations. They do not require an external energy input.

KA 2 is a float-controlled steam trap for all applications and especially suitable for corrosive condensate and applications in the food industry. It is completely made of stainless steel with excellent corrosion-resistance. The valve is fitted with a soft seal.

Top and bottom sections of the valve body are connected by a clamp ring and two bolts. Servicing/maintenance is easy and does not call for special tooling.

The simple design makes it easy to specify, install, handle and service these valves in an industrial environment.

## Standard

- » All stainless steel construction
- » Quick-release body clamp ring
- » Manual bleed valve

## Options

- » Various seal materials suitable for your medium
- » Expansion pipe connection in the valve top section for draining condensate from compressed air or gases
- » No manual bleed valve
- » Special versions on request

## Product



Picture similar

## Technical specification

### Pressure ranges [bar]

0 - 2	0 - 6	0 - 12	0 - 13*
-------	-------	--------	---------

\*option

Please state working pressure range when enquiring or ordering.

### Flow rate [l/h]\*

Δp bar	G 1/2 - G 3/4 x 1/2A			G 1 x 3/4A, DN 25 x 3/4A			
	pressure ranges bar			pressure ranges bar			
	0 - 2	0 - 6	0 - 12	0 - 2	0 - 6	0 - 12	0 - 13
0.02	30	11	2	150	34	11	-
0.05	50	17	4	240	54	17	-
0.1	70	19	6	350	75	25	220
0.2	100	28	9	490	105	35	320
0.5	160	40	12	780	170	55	710
1	230	70	18	1100	240	75	980
2	350	110	27	1570	340	110	1200
4	-	160	46	-	480	155	1200
6	-	200	50	-	590	190	1200
8	-	-	60	-	-	220	1200
10	-	-	70	-	-	250	1180
12	-	-	75	-	-	270	1030
13	-	-	-	-	-	-	950

\*Cold condensate (20°C)

# LEVEL CONTROL Steam trap KA 2

Valve for small flow rates



## Materials

Materials	
Body	Stainless steel
Body seal	FEPM
Seat	Stainless steel
Float	Stainless steel
Valve seal	FFKM

\*All materials equal or of higher quality

## Dimensions and weights

Dimensions [mm]				
size	nominal diameter			
	G 1/2 x 1/2A	G 3/4 x 1/2A	G 1 x 3/4A	DN 25 x 3/4A
A*	87	27	140	140
B*	100	135	145	160
C	45	-	40	40
D	140	140	200	200

\*overall length tolerances in acc. with DIN EN 558

Weights [kg]	
0.85	
Customs tariff number	
84818059	

**G 1/2 x 1/2A**  
Compensation  
line connection G 1/4

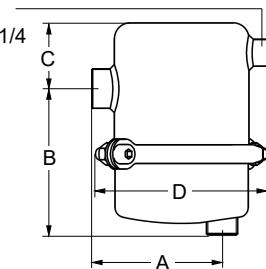

**G 3/4 x 1/2A**  
Manual bleed valve

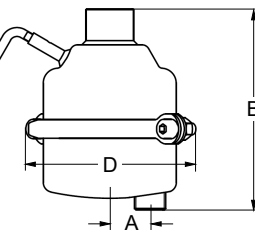

**G 1 x 3/4A**

Manual bleed valve

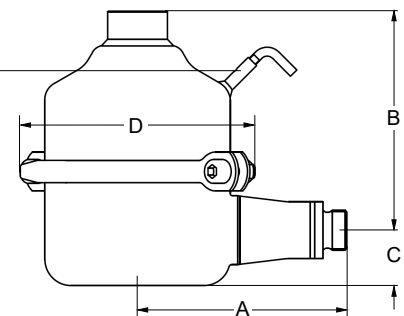

Authorised Distributor:



46, Jalan SS 22/21, Damansara Jaya,  
47400 Petaling Jaya,  
Selangor Darul Ehsan, Malaysia.

Email: [ampmech@ampmech.com](mailto:ampmech@ampmech.com)

Website: [www.ampmech.com](http://www.ampmech.com)

Please send us your enquiry and allow us to advise you. Special designs on request.  
The pressure has always been indicated as overpressure. Mankenberg reserves the right to alter technical specifications without notice.